

ACCESORIOS PVC PRESION PVC PRESSURE FITTINGS RACCORDS PVC PRESSION

BS (British Standard)

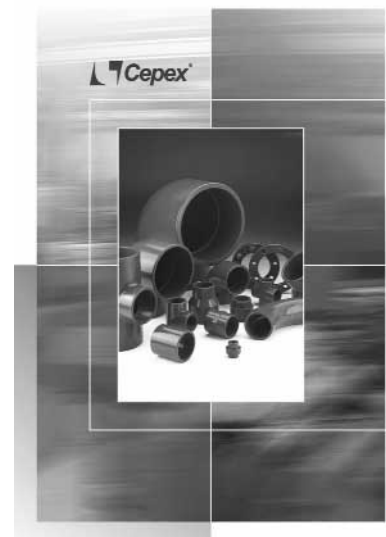

NOT FOR USE WITH COMPRESSED AIR OR GAS

WARNING:

DO NOT USE COMPRESSED AIR OR GAS TO TEST ANY PVC OR CPVC THERMOPLASTIC PIPING PRODUCT OR SYSTEM.

DO NOT USE DEVICES PROPELLED BY COMPRESSED AIR OR GAS TO CLEAR SYSTEMS.

THESE PRACTICES MAY RESULT IN EXPLOSIVE FRAGMENTATION OF SYSTEM PIPING AND COMPONENTS CAUSING SERIOUS OR FATAL BODILY INJURY.

© COPYRIGHT 2001, CEPEX HOLDING, S.A. - ALL RIGHTS RESERVED

WE RESERVE THE RIGHT TO CHANGE ALL OR PART OF THE FEATURES OF THE ARTICLES OR CONTENTS OF THIS DOCUMENT, WITHOUT PRIOR NOTICE
PRODUCT PHOTOGRAPHS AND DRAWINGS ARE REPRESENTATIVE AND MAY NOT FULLY REFLECT PRODUCT CONFIGURATIONS

<p>90° AND 45° ELBOWS CODOS DE 90° Y 45° COUDES DE 90° ET 45°</p>		<p>3</p>
<p>TEES TÉS TÉS</p>		<p>4</p>
<p>REDUCTIONS AND UNION SOCKETS MANGUITOS UNIÓN Y REDUCCIONES MANCHONS ET REDUCTIONS</p>		<p>5</p>
<p>3 PIECE AND SELF-ALIGN UNIONS ENLACES 3 PIEZAS Y UNIONES ORIENTABLES RACCORDS UNION 3 PIÈCES ET UNIONS RÉGLABLES</p>		<p>7</p>
<p>SIGHT GLASS VISOR DE LÍQUIDOS VOYANTS DE CONTRÔLE</p>		<p>9</p>

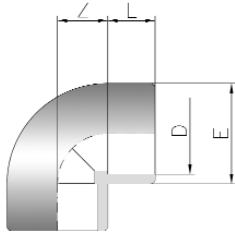
01

ELBOW 90°
solvent socket

CODO 90°
para encolar

COUDE 90°
F x F à coller

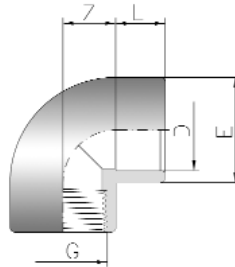

REF.	L	Z	E	DN	PACK.	kg	Q	D	CODE
05 01 901	16	11	27	15	C	5,1	8x35 = 280	1/2"	07137
05 01 902	19	13,5	33	20	C	5,2	4x45 = 180	3/4"	07138
05 01 903	22	17	41	25	C	5,2	2x50 = 100	1"	07139
05 01 904	26	21	50	32	D	8,5	2x55 = 110	1 1/4"	07140
05 01 905	31	26	61	40	E	21,6	4x30 = 120	1 1/2"	07141
05 01 906	38	32,5	76	50	E	23,4	72	2"	07142
05 01 075	44	38,5	90	65	E	22,3	45	2 1/2"	07118
05 01 908	51	46	108	80	E	22,3	28	3"	07144
05 01 910	61	56	131	100	E	19,2	15	4"	07145

01

ELBOW 90°
solvent socket, BSP female thread

CODO MIXTO 90°
para encolar y roscar hembra

COUDE 90°
F à coller x F à visser

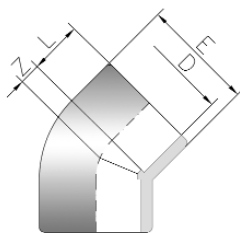

REF.	L	Z	E	DN	PACK.	kg	Q	D x G	CODE
05 01 931	16	11	27	15	C	6,3	8x40 = 320	1/2" x 1/2"	07146
05 01 932	19	13,5	33	20	C	6,0	4x45 = 180	3/4" x 3/4"	07147
05 01 933	22	17	41	25	C	6,0	2x40 = 80	1" x 1"	07148
05 01 934	26	21	50	32	D	13,6	2x55 = 110	1 1/4" x 1 1/4"	07149
05 01 935	31	26	61	40	E	21,4	4x30 = 120	1 1/2" x 1 1/2"	07150
05 01 936	38	32,5	76	50	E	23,6	72	2" x 2"	07151

02

ELBOW 45°
solvent socket

CODO 45°
para encolar

COUDE 45°
F x F à coller



REF.	L	Z	E	DN	PACK.	kg	Q	D	CODE
05 02 901	16	5	28	15	C	7,7	8x45 = 360	1/2"	07152
05 02 902	19	6	34,5	20	C	6,2	4x50 = 200	3/4"	07153
05 02 903	22	7,5	43	25	C	6,2	2x60 = 120	1"	07154
05 02 904	26	9,5	52	32	D	9,9	2x60 = 120	1 1/4"	07155
05 02 905	31	11,5	61	40	E	26,3	4x40 = 160	1 1/2"	07156
05 02 906	38	14	76	50	E	22,9	2x36 = 72	2"	07157
05 02 075	44	16,5	93	65	E	22,4	52	2 1/2"	07152
05 02 908	51	19,5	109	80	E	20,9	30	3"	07159
05 02 910	61	23,5	133	100	E	17,8	18	4"	07160

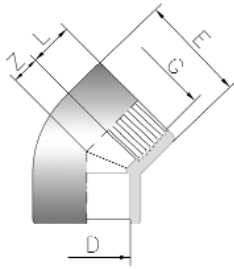

ELBOW 45°
solvent socket, BSP female thread

CODO MIXTO 45°
para encolar y roscar hembra

COUDE 45°
F à coller x F à visser



02

REF.	L	Z	E	DN	PACK.	kg	Q	D x G	CODE
05 02 931	16	5	28	15	C	6,8	8x45 = 360	1/2" x 1/2"	07161
05 02 932	19	6	34,5	20	C	6,8	4x50 = 200	3/4" x 3/4"	07162
05 02 933	22	7,5	43	25	C	6,2	2x50 = 100	1" x 1"	07163
05 02 934	26	9,5	52	32	D	11,2	2x60 = 120	1 1/4" x 1 1/4"	07164
05 02 935	31	11,5	63	40	E	27,6	4x40 = 160	1 1/2" x 1 1/2"	07165
05 02 936	38	14	79	50	E	23,0	2x36 = 72	2" x 2"	07166

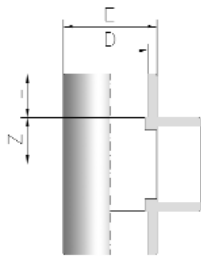

TEE 90°
solvent socket

TÉ 90°
iguales, para encolar

TÉ 90°
F x F x F à coller



03

REF.	L	Z	E	DN	PACK.	kg	Q	D	CODE
05 03 901	16	11	27	15	C	6,2	4x60 = 240	1/2"	07167
05 03 902	19	13,5	33	20	C	5,4	4x30 = 120	3/4"	07168
05 03 903	22	17	41	25	C	6,4	2x40 = 80	1"	07169
05 03 904	26	21	50	32	D	11,0	2x45 = 90	1 1/4"	07170
05 03 905	31	26	61	40	E	22,0	4x24 = 96	1 1/2"	07171
05 03 906	38	32,5	76	50	E	26,5	60	2"	07172
05 03 075	44	38,5	90	65	E	19,1	34	2 1/2"	01786
05 03 908	51	46	108	80	E	19,9	20	3"	07174
05 03 910	61	56	131	100	E	14,7	10	4"	07175

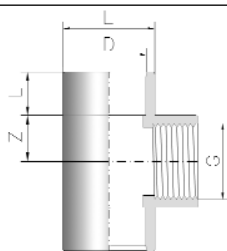

TEE 90°
solvent socket, BSP female thread

TÉ MIXTA 90°
para encolar y roscar hembra

TÉ 90°
F à coller x F à visser x F à coller



03

REF.	L	Z	E	DN	PACK.	kg	Q	D x G	CODE
05 03 931	16	11	27	15	C	6,4	4x60 = 240	1/2" x 1/2"	07176
05 03 932	19	13,5	33	20	C	5,6	4x30 = 120	3/4" x 3/4"	07177
05 03 933	22	17	41	25	C	6,8	2x36 = 72	1" x 1"	07178
05 03 934	26	21	50	32	D	13,4	2x40 = 80	1 1/4" x 1 1/4"	07179
05 03 935	31	26	61	40	E	20,8	4x22 = 88	1 1/2" x 1 1/2"	07180
05 03 936	38	32,5	76	50	E	21,3	2x26 = 52	2" x 2"	07181

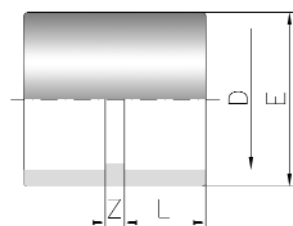
05

SOCKET
solvent socket

MANGUITO UNIÓN
para encolar

MANCHON
F x F à coller

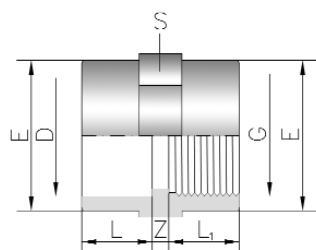

REF.	L	Z	E	DN	PACK.	kg	Q	D	CODE
05 05 901	16	3	27	15	C	7,7	8x60 = 480	1/2"	07182
05 05 902	19	3	33	20	C	6,5	4x70 = 280	3/4"	07183
05 05 903	22	3	41	25	C	6,2	4x40 = 160	1"	07184
05 05 904	26	3	50	32	C	4,9	2x45 = 90	1 1/4"	07185
05 05 905	31	3	61	40	D	11,3	2x60 = 120	1 1/2"	07186
05 05 906	38	3	75	50	D	11,2	2x30 = 60	2"	07187
05 05 075	44	4	90	65	D	10,4	2x18 = 36	2 1/2"	01878
05 05 908	51	5	108	80	D	8,9	2x9 = 18	3"	07189
05 05 910	61	6	131	100	E	18,0	2x12 = 24	4"	07190

05

ADAPTOR SOCKET
solvent socket, BSP female thread

MANGUITO UNIÓN MIXTO
para encolar y roscar hembra

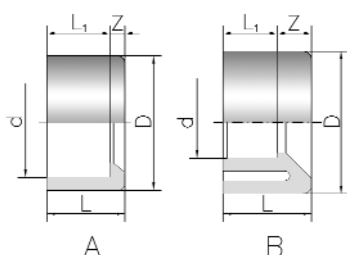
MANCHON
F à coller x F à visser



REF.	L	L ₁	Z	E	S	DN	PACK.	kg	Q	D x G	CODE
05 05 931	16	16	3	27	27	15	C	6,2	8x50 = 400	1/2" x 1/2"	07191
05 05 932	19	19	3	33	33	20	C	6,3	8x30 = 240	3/4" x 3/4"	07192
05 05 933	22	22	3	41	41	25	C	7,1	4x36 = 144	1" x 1"	07193
05 05 934	26	26	3	50	50	32	C	7,4	2x45 = 90	1 1/4" x 1 1/4"	07194
05 05 935	31	31	3	61	61	40	D	13,2	2x60 = 120	1 1/2" x 1 1/2"	07195
05 05 936	38	38	3	75	75	50	D	12,5	2x30 = 60	2" x 2"	07196
05 05 475	44	44	4	90	90	65	D	10,8	2x18 = 36	2 1/2" x 2 1/2"	01895

06

REDUCING BUSH
solvent socket

CASQUILLO REDUCCIÓN
para encolar

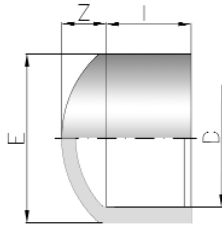
REDUCTION SIMPLE
M x F à coller

REF.	L	Z	L ₁	MOD.	DN	PACK.	kg	Q	D x d	CODE
05 06 920	19	3	16	A	15	C	3,5	8x75 = 600	3/4" x 1/2"	07198
05 06 930	22	3	19	A	20	C	5,4	8x60 = 480	1" x 3/4"	07199
05 06 931	22	6	16	A	15	C	6,8	8x60 = 480	1" x 1/2"	07200
05 06 940	26	4	22	A	25	C	6,5	4x70 = 280	1 1/4" x 1"	07201
05 06 941	26	7	19	A	20	C	7,5	4x75 = 300	1 1/4" x 3/4"	07202
05 06 950	31	5	26	A	32	C	4,5	4x45 = 180	1 1/2" x 1 1/4"	07203
05 06 951	31	9	22	A	25	C	7,5	4x45 = 180	1 1/2" x 1"	07204
05 06 960	38	7	31	A	40	C	6,9	2x50 = 100	2" x 1 1/2"	07205
05 06 970	44	6	38	A	50	C	5,5	2x30 = 60	2 1/2" x 2"	07206
05 06 980	51	7	44	A	65	D	10,9	2x36 = 72	3" x 2 1/2"	07207
05 06 990	61	10	51	A	80	D	11,6	2x15 = 30	4" x 3"	07208



CAP
solvent socket

TAPÓN
para encolar

BOUCHON
emboiture à coller



07

REF.	L	Z	E	DN	PACK.	kg	Q	D	CODE
05 07 901	16	8	26,3	15	C	4,3	8x75 = 600	1/2"	07209
05 07 902	19	9	32,6	20	C	6,7	8x60 = 480	3/4"	07210
05 07 903	22	10	40	25	C	6,8	4x70 = 280	1"	07211
05 07 904	26	12	50	32	C	7,3	4x45 = 180	1 1/4"	07212
05 07 905	31	15	63	40	C	7,2	2x45 = 90	1 1/2"	07213
05 07 906	38	17	75	50	C	6,3	2x25 = 50	2"	07214
05 07 075	44	19	75	65	C	6,5	2x16 = 32	2 1/2"	01949
05 07 908	51	23	110	80	D	13,2	2x17 = 34	3"	07216
05 07 910	61	28	131	100	D	9,9	2x8 = 16	4"	07803

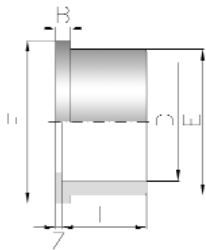

FLANGE ADAPTOR (STUB FLANGE) PVC
solvent socket

MANGUITO PORTABRIDAS
para encolar

COLLET PORTE BRIDES
à coller



10

REF.	L	Z	B	E	F	DN	PACK.	kg	Q	D	CODE
05 10 906	38	3	9	76	90	50	C	4,4	2x18 = 36	2"	07804
05 10 075	44	3	10	90	106	65	C	5,4	2x14 = 28	2 1/2"	02022
05 10 908	51	5	11	108	125	80	D	9,3	2x16 = 32	3"	07218
05 10 910	61	5	12	131	150	100	E	16,7	2x20 = 40	4"	07219
05 10 140	76	5	14	165	188	125	E	20,3	24	5"	02026
05 10 914	86	5	16	188	213	150	E	19,0	16	6"	07221
05 10 917	119	6	25	248	274	200	E	15,1	6	8"	07222

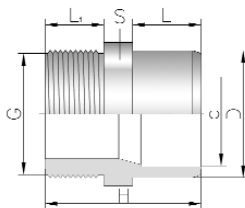

ADAPTOR NIPPLE
BSP male thread

MACHÓN MIXTO
para encolar y roscar macho

EMBOUT FILETÉ
M - F à coller x M à visser



15

REF.	L	L ₁	H	S	DN	PACK.	kg	Q	D - d x G	CODE
05 15 931	16	14	42	27	15	C	6,0	8x50 = 400	1/2" - 3/8" x 1/2"	07238
05 15 932	19	16	47	32	20	C	4,9	8x30 = 240	3/4" - 1/2" x 3/4"	07239
05 15 933	22	19	54	36	25	C	5,6	4x45 = 180	1" - 3/4" x 1"	07240
05 15 934	26	21	60	46	32	C	6,8	2x60 = 120	1 1/4" - 1" x 1 1/4"	07241
05 15 935	31	25	70	55	40	D	13,7	2x80 = 160	1 1/2" - 1 1/4" x 1 1/2"	07242
05 15 936	38	25	78	65	50	D	13,5	2x48 = 96	2" - 1 1/2" x 2"	07243
05 15 475	44	30	89	78	65	D	10,1	2x24 = 48	2 1/2" - 2" x 2 1/2"	02091
05 15 938	51	33	99	93	80	D	11,5	2x18 = 36	3" - 2 1/2" x 3"	07245

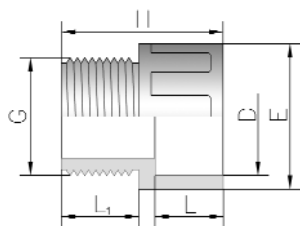

ADAPTOR BUSH
solvent socket, BSP male thread

TERMINAL ROSCA MACHO
para encolar y roscar macho

EMBOUT FILETÉ
F à coller x M à visser



17

REF.	L	L ₁	E	H	DN	PACK.	kg	Q	D x G	CODE
05 17 931	16	14	28	38	15	C	6,4	8x50 = 400	1/2" x 1/2"	07246
05 17 932	19	16	34	42	20	C	5,8	8x30 = 240	3/4" x 3/4"	07247
05 17 933	22	19	41	50	25	C	7,6	4x48 = 192	1" x 1"	07248
05 17 934	26	21	51	55	32	C	5,4	2x45 = 90	1 1/4" x 1 1/4"	07249
05 17 935	31	30	62	65	40	C	7,2	2x40 = 80	1 1/2" x 1 1/2"	07250
05 17 936	38	30	77,5	75	50	D	15,4	2x48 = 96	2" x 2"	07251
05 17 475	44	30	90	85	65	D	16,1	2x30 = 60	2 1/2" x 2 1/2"	02108
05 17 938	51	33	108	98	80	D	11,1	2x12 = 24	3" x 3"	07253
05 17 940	61	40	131	115	100	D	8,6	2x6 = 12	4" x 4"	07254

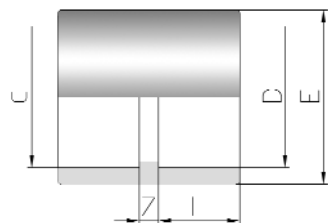

METRIC/IMPERIAL ADAPTOR SOCKET
solvent socket

MANGUITO ADAPTADOR MÉTRICO/IMPERIAL
para encolar

MANCHON D'ADAPTATION MÉTRIQUE/IMPÉRIAL
F x F à coller



27

REF.	L	Z	E	DN	PACK.	kg	Q	D x d	CODE
05 27 901	16	3	27	15	C	7,4	8x60 = 480	20 x 1/2"	07229
05 27 902	19	3	33	20	C	6,5	4x70 = 280	25 x 3/4"	07230
05 27 903	22	3	41	25	C	6,2	4x40 = 160	32 x 1"	07231
05 27 904	26	3	50	32	C	5,9	2x45 = 90	40 x 1 1/4"	07232
05 27 905	31	3	61	40	D	12,2	2x60 = 120	50 x 1 1/2"	07233
05 27 906	38	3	75	50	D	10,4	2x30 = 60	63 x 2"	07234
05 27 908	51	5	108	80	D	9,2	2x9 = 18	90 x 3"	07236
05 27 910	61	6	135	100	E	17,1	2x12 = 24	110 x 4"	07237

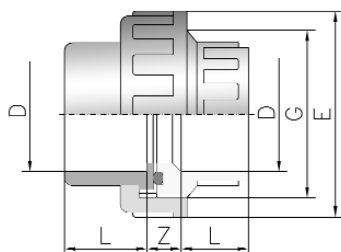

3 PIECE UNION
solvent socket

ENLACE 3 PIEZAS
para encolar

RACCORD UNION
F x F à coller



50

REF.	L	Z	G	E	O Ring / Anillo tórico / Joint torique	DN	PACK.	kg	Q	D	CODE
05 50 901	16	13	1"	41	20,2 x 3,5	15	C	6,3	8x20 = 160	1/2"	07332
05 50 902	19	13	1 1/4"	52	28,2 x 3,5	20	C	7,0	4x25 = 100	3/4"	07333
05 50 903	22	13	1 1/2"	60	32,9 x 3,5	25	C	6,0	2x30 = 60	1"	07334
05 50 904	26	15	2"	74	40,6 x 5,3	32	C	6,6	2x20 = 40	1 1/4"	07335
05 50 905	31	17	2 1/4"	80	47 x 5,3	40	D	11,8	2x30 = 60	1 1/2"	07336
05 50 906	38	21	2 3/4"	99	59,7 x 5,3	50	D	11,3	2x15 = 30	2"	07337
05 50 075	44	21	3 1/2"	120	75,6 x 5,3	65	D	9,7	2x8 = 16	2 1/2"	02333
05 50 908	51	24	4"	138	91,4 x 5,3	80	D	8,7	2x5 = 10	3"	07806
05 50 910	61	26	5 1/2"	179	110,5 x 5,3	100	D	9,2	2x3 = 6	4"	07807

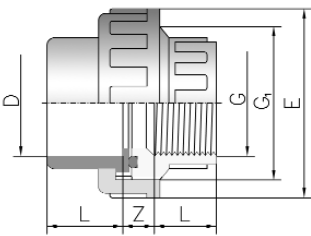

3 PIECE UNION
solvent socket, BSP female thread

ENLACE MIXTO 3 PIEZAS
para encolar y roscar hembra

RACCORD UNION
F à coller x F à visser



50

REF.	L	Z	G ₁	E	O Ring / Anillo tórico / Joint torique	DN	PACK.	kg	Q	D x G	CODE
05 50 931	16	13	1"	41	20,2 x 3,5	15	C	6,9	8x20 = 160	1/2" x 1/2"	07255
05 50 932	19	13	1 1/4"	52	28,2 x 3,5	20	C	7,1	4x25 = 100	3/4" x 3/4"	07256
05 50 933	22	13	1 1/2"	60	32,9 x 3,5	25	C	6,1	2x30 = 60	1" x 1"	07257
05 50 934	26	15	2"	74	40,6 x 5,3	32	C	6,7	2x20 = 40	1 1/4" x 1 1/4"	07258
05 50 935	31	17	2 1/4"	90	47 x 5,3	40	D	12,8	2x30 = 60	1 1/2" x 1 1/2"	07259
05 50 936	38	21	2 3/4"	108	59,7 x 5,3	50	D	11,8	2x15 = 30	2" x 2"	07260
05 50 475	44	21	3 1/2"	120	75,6 x 5,3	65	D	10,0	2x8 = 16	2 1/2" x 2 1/2"	02342
05 50 938	51	24	4"	138	91,4 x 5,3	80	D	8,9	2x5 = 10	3" x 3"	07808
05 50 940	61	26	5 1/2"	179	110,5 x 5,3	100	D	10,6	2x3 = 6	4" x 4"	07809

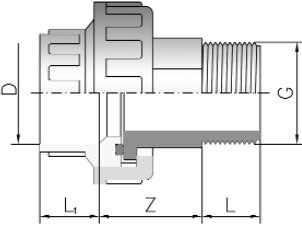

3 PIECE UNION
solvent socket, BSP male thread

ENLACE MIXTO M/H 3 PIEZAS
para encolar y roscar macho

RACCORD UNION
F à coller x M à visser



51

REF.	L	L ₁	Z	DN	PACK.	kg	Q	D x G	CODE
05 51 931	16	15	33	15	C	6,9	8x18 = 144	1/2" x 1/2"	07810
05 51 932	19	16	35	20	C	6,3	4x20 = 80	3/4" x 3/4"	07811
05 51 933	22	19	40	25	C	7,1	2x30 = 60	1" x 1"	07812
05 51 934	26	21	40	32	C	6,9	2x18 = 36	1 1/4" x 1 1/4"	07813
05 51 935	31	21	48	40	D	11,8	2x25 = 50	1 1/2" x 1 1/2"	07262
05 51 936	38	25	62	50	D	12,4	2x14 = 28	2" x 2"	07263
05 51 475	44	30	70	65	D	8,6	2x6 = 12	2 1/2" x 2 1/2"	02359
05 51 938	51	33	62	80	D	10,3	2x5 = 10	3" x 3"	07814
05 51 940	61	39	70	100	D	8,1	2x2 = 4	4" x 4"	07815

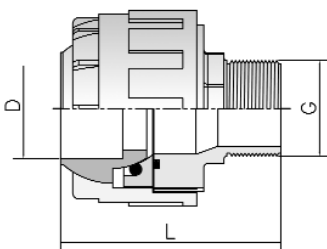

SELF-ALIGN UNION
MANGUITO ORIENTABLE
MANCHON REGLABLE ACCORD C1
(Max. ± 4°)



57

PN 10

REF.	L	DN	PACK.	kg	Q	D x G	CODE
05 57 955	110	40	D	-	-	1 1/2" x 1 1/2"	21081

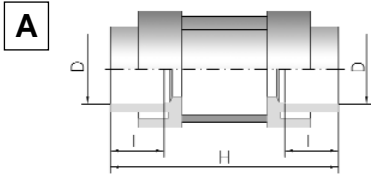
54

SIGHT GLASS
VISOR DE LÍQUIDOS
VOYANT DE CONTROLE

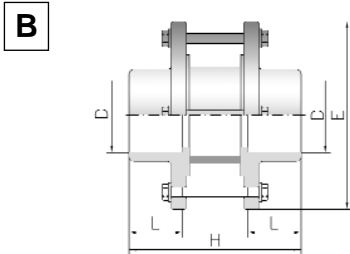

SIGHT GLASS MATERIAL	Ø 50-63 PMMA
MATERIAL VISOR	Ø 75-225 SAN
MATÉRIEL DU VOYANT	

4 SCREWS
4 TORNILLOS
4 BOULONS

SOLVENT SOCKET - PARA ENCOLAR - F x F À COLLER

REF.	L	H	E	MOD.	DN	PACK	kg	Q	D	CODE
05 54 905	31	130	80	A	40	C	5,4	2x6 = 12	1 1/2"	21082
05 54 906	38	159	92	A	50	C	7,9	2x6 = 12	2"	21083
05 54 075	44	165	185	B	65	D	10,1	4x1 = 4	2 1/2"	02389
05 54 908	51	180	200	B	80	D	13,3	4x1 = 4	3"	21084
05 54 910	61	250	220	B	100	D	8,4	2x1 = 2	4"	21085



Lluís Companys 51-53 - 08400 Granollers (Barcelona) Spain
Phone: +(34) 93 870 42 08 Fax: +(34) 93 879 57 11
E-mail: cepex@cepex.com
Website: www.cepex.com